



**DRESS YOUR POOL
IN COLOR
WITH TEXPOOL**

TEXPOOL NG 11

**Reinforced 1.5 mm waterproofing membrane,
for that touch of elegance**

tex|POOL



TEXPOOL RANGE

1 TEXPOOL NG 11 UNICOLOR STANDARD:

Standard finishing, available in 15 colours



53594/CA
LIGHT BLUE*



53594/AB
BLUE*



53594/DB
DARK BLUE*

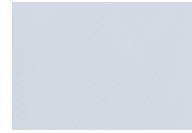

53594/HB
WHITE*

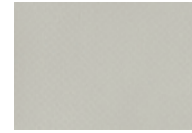

53594/SA
SAND*



53594/GC
PEARL GREY*



53594/GB
DARK GREY*



53594/GA
BASALT GREY*



53594/NB
BLACK ANTRACITE*



53594/GO
PINK*



53594/VD
GREEN WATER*



53594/VC
CARIBBEAN GREEN*



53594/VM
WILD MUSK*



53594/GL
YELLOW*



53594/RA
RED*

2 TEXPOOL NG 11 UNICOLOR SUPERIOR GLOSSY:

Glossy finishing, available in 6 colours



57503/CA
LIGHT BLUE



57503/AB
BLUE

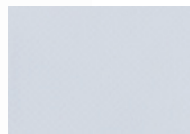

57503/HB
WHITE

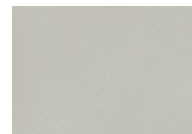

57503/SA
SAND



57503/GC
PEARL GREY



57503/GB
DARK GREY

3 TEXPOOL NG 11 PRINTED GLOSSY:

Printed glossy finishing, available in 10 colours

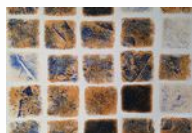

57504/MSI
ALHAMBRA

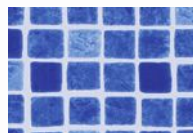

57504/MMB
MARBELLA*

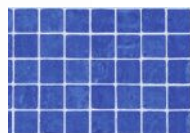

57504/MNB
BLUE MOSAIC*

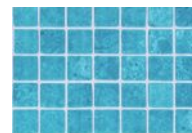

57504/MNG
GREEN MOSAIC

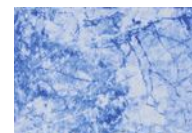

57504/SB
SKY BLUE



57504/WF
WHITE FLORENCE



57504/PB
BLACK PEARL

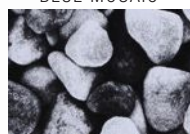

57504/STON
STONE



57504/GOLD
GOLD MOSAIC

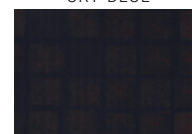

57504/MMGO
MARBELLA GOLD

*4 TEXPOOL NG 11 ANTISKID:

Antiskid finishing, available in 17 colours

The special glossy finishing of TEXPOOL NG 11 ANTISKID membrane provides better resistance to U.V., sunscreens and any microorganisms. It also allows an easier maintenance of the membrane.

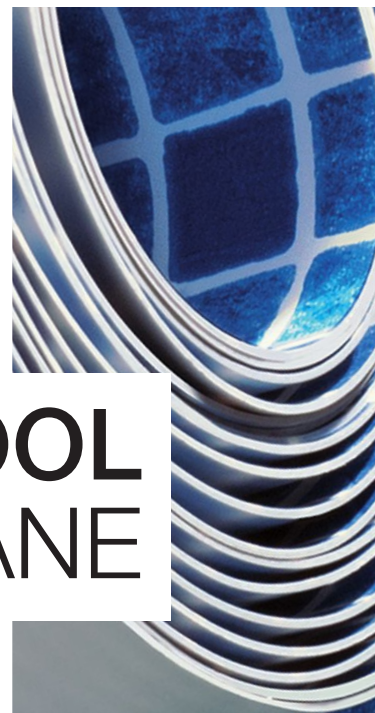

ADVANTAGES OF TEXPOOL REINFORCED MEMBRANE

1 Flexibility, adaptable to any shape

2 Fast installation, very good weldability

4
Colour stability

3 Wide range of highly aesthetic designs

5 High mechanical strength and puncturing resistance

6 Resistance to commonly used water treatment products



7 High weathering and U.V. resistance

9 Resistance to cold - heat cycles

8
Resistance to microorganisms thanks to "BIO_SHIELD" treatment

10
Waterproofing: total protection of the pool



「 The membranes TEXPOOL NG 11 are the result of years of research and development. 」

TECHNICAL CHARACTERISTICS

STANDARD EN 15836/2



DESCRIPTION

Synthetic membrane of PVC-P manufactured by cast process, consisting of 4 layers of Plastisol having different physical-chemical properties and reinforced with polyester mesh.

PROPERTIES

- High weathering and U.V. resistance
- High mechanical strength
- Puncturing resistance
- Excellent weldability
- Resistance to commonly used water treatment products

STANDARD PRODUCTION

- **Thickness:** 1,5 mm
- **Width:** 1,60 m / 1,50* m
- **Length:** 25 m / 10* m

* Available in antiskid version

More RAL colours, glossy finishing and antiskid versions available upon request and extra cost can apply.

CHARACTERISTICS	TEXPOOL NG 11	TEXPOOL NG 11 GLOSSY UNICOLOR	TEXPOOL NG 11 GLOSSY PRINTED	TESTING METHOD
Thickness (mm)	1,50	1,50	1,50	UNI EN 1849-2
Width (mm)	1,60	1,60	1,60	UNI EN 1848-2
length	≥ nominal value	≥ nominal value	≥ nominal value	UNI EN 1848-2
Flatness (mm)	≤ 10	≤ 10	≤ 10	UNI EN 1848-2
Rectitude (mm)	≤ 30	≤ 30	≤ 30	UNI EN 1848-2
Mass per unit of water (kg / sqm)	1,80	1,80	1,80	UNI EN 1849-2
Water absorption (168 hours 23 ± 2°C) (%)	≤ 1,0	≤ 1,0	≤ 1,0	EN ISO 62 met. 1
CaCO ₃ Content (%)	≤ 3,0	≤ 3,0	≤ 3,0	EN 15836 - 2 all. A
Tensile strength (N/5cm)	≥ 1100	≥ 1100	≥ 1100	UNI EN 12311-2 met. A
Elongation at break of the reinforcement (%)	≥ 15 e ≤ 30	≥ 15 e ≤ 30	≥ 15 e ≤ 30	UNI EN 12311-2 met. A
Tear resistance (N)	≥ 180	≥ 180	≥ 180	UNI EN 12310-2
Dimensional stability (%)	≤ 0,5	≤ 0,5	≤ 0,5	UNI EN 1107-2
Cold pliability (°C)	≤ - 25	≤ - 25	≤ - 25	UNI EN 495-5
Peel resistance (overlapping) (N/5cm)	≥ 80	≥ 80	≥ 80	UNI EN 12316-2
Slip resistance (°)	≥ 24 (*)	--	--	EN 15836-2 all. B UNI EN 13451-1
Weathering resistance: - Exposure of 648 MJ/m ² UV between 300 and 400 nm - Contrast level according grayscale	≥ 3000 hours ≥ level 3	≥ 3000 hours ≥ level 3	≥ 3000 hours ≥ level 3	EN ISO 4892-2 met. A cycle nr 1 EN 20105 - A02
Resistance to microorganisms: - Mass loss (%)	≤ 5,0	≤ 1,0	≤ 1,0	EN ISO 846 met. D
Resistance to bacteria Streptovercillium reticulum	Absence of stains	Absence of stains	Absence of stains	EN ISO 846 met. C Ceppo: ATCC 25607
Resistance to chlorine: - Changes color depending on the grayscale	≥ level 3	≥ level 3	≥ level 3	EN 15836 - 2 all. C
Stain resistance: - Changes color depending on the grayscale	≥ level 2	≥ level 4	≥ level 4	EN 15836 - 2 all. D
Stain resistance after abrasion: - Changes color depending on the grayscale	--	--	≥ level 4	EN 15836-par. 6.3.1 EN 15836 - 2 all. D

INSTALLATION

tex POOL

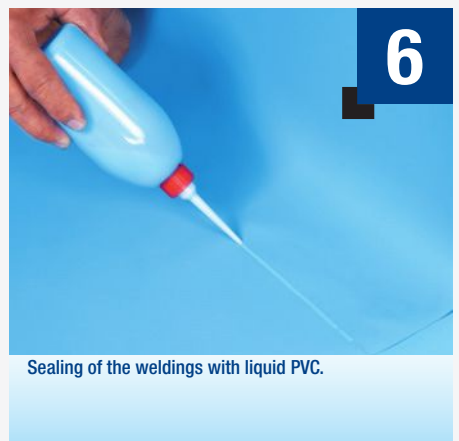
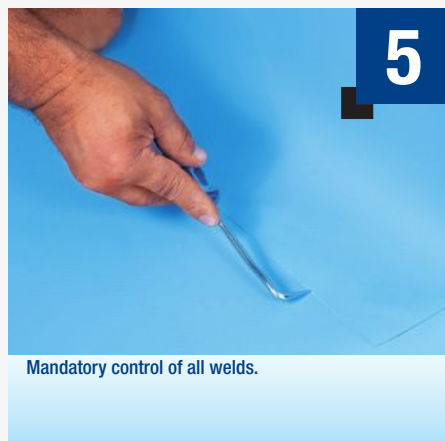
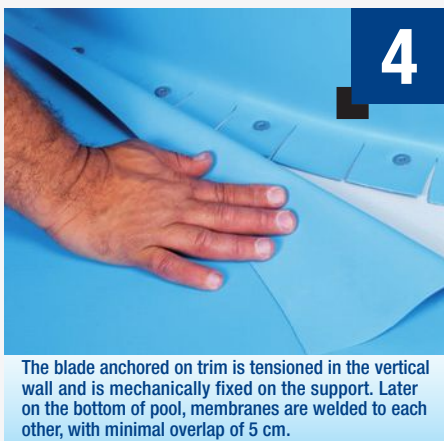
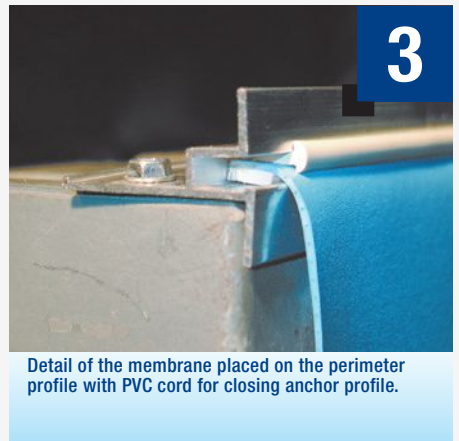
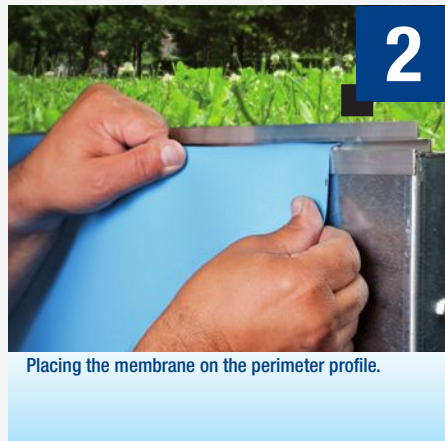
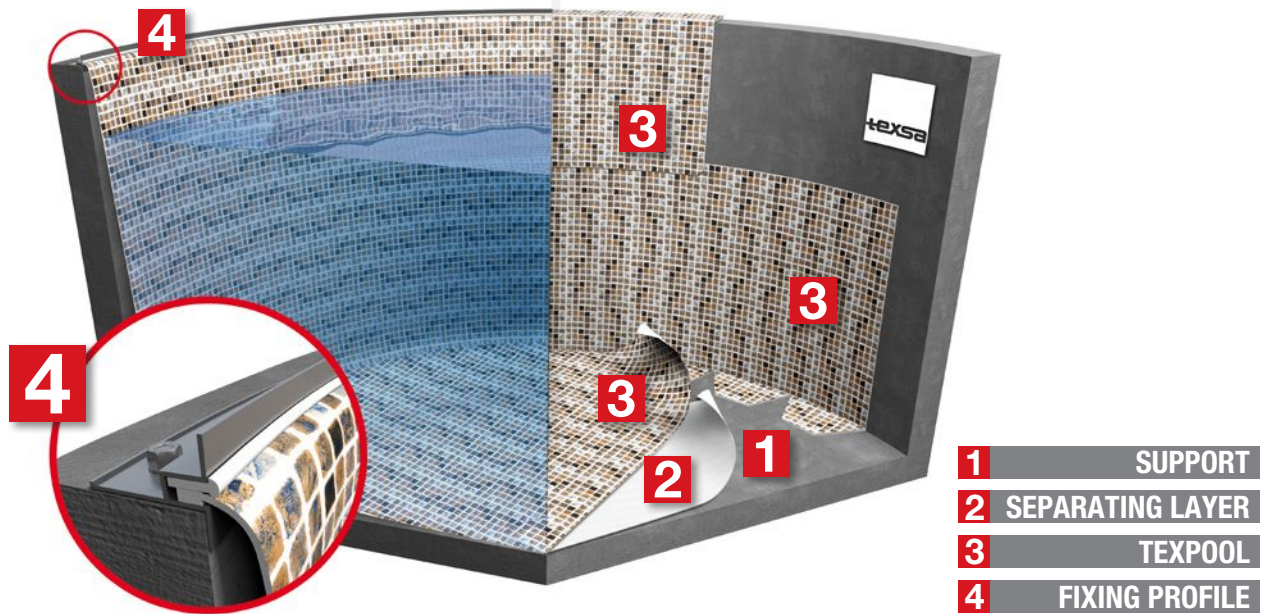



tex POOL

TEXSA SYSTEMS, S.L.U.
C/ Ferro, 7 - Pol. Ind. Can Pelegrí
08755 Castellbisbal - Barcelona. Spain
www.texsa.com

